

# MAXGRIND® LITE

## Pill Crusher & Grinder

### Directions:

1. If using a 1 oz. plastic med cup to collect crushed meds (optional), remove the bottom clear cup and insert a disposable 1 oz. plastic cup. Snap clear cup back on with a slight turn and push.
2. Remove the top and place pill(s) into the well. Replace the top and twist until the top tightens. Twist clockwise until you feel the initial crush/breaking of pills.
3. After the initial crush, turn a slight twist counterclockwise into free spin mode where grinding will start. Now with slight pressure on the top you can freely twist the crusher back and forth like a pepper grinder to sift powder through the crusher well slots into the bottom clear cup. For best results, continue to free spin in an upright position to circulate air inside the crusher to sift any remaining powder.
4. Remove the bottom clear cup. If you crushed into a 1 oz. disposable plastic med cup remove it from the clear cup. If you crushed directly into the bottom clear cup you can empty or mix in the cup. Convenient for adding water and drawing into a feeding syringe.

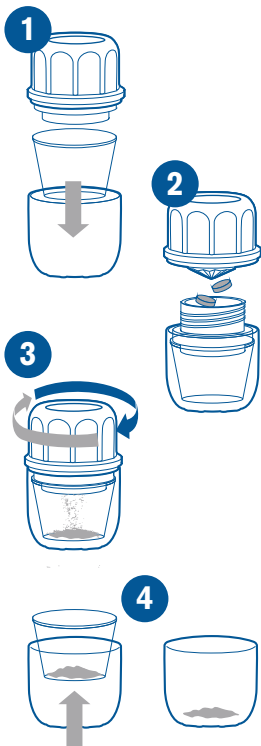

**MAXGRIND** should be kept in an upright position when crushing.

**Cleaning:** Rinse with warm water and let dry before initial use. After each use repeat as needed to remove any pill residue from crusher.

**Note:** Enteric-coated tablets are intended to be swallowed whole and should never be crushed before taking. Consult your physician or pharmacist before crushing medications.

**Caution: Keep out of reach of children.**

### Distributed By:

Maxpert Medical, LLC.  
Galloway, OH 43119  
866-231-1222  
MADE IN CHINA